

# A step-change at the Napier Works

ravensdown 

- Established in 1953, Ravensdown Napier Works is the largest remaining superphosphate manufacturing facility in New Zealand
- Past major improvements delivered in environmental performance
- More efficient use of nutrients is a win-win for food production and environment
- Committed to a step-change to reduce adverse effects and future-proof productivity



# Site Improvement Projects

- Improvements across site to manage contaminant sources
- Replacement of Manufacturing Scrubbers and Acid Plant Converter will reduce day-to-day running emissions
- Staged stormwater and process water treatment targeting National Freshwater Standards
- Want to stay updated? Visit [ravensdown.co.nz/ravensdown/napier-21-consent](https://ravensdown.co.nz/ravensdown/napier-21-consent)

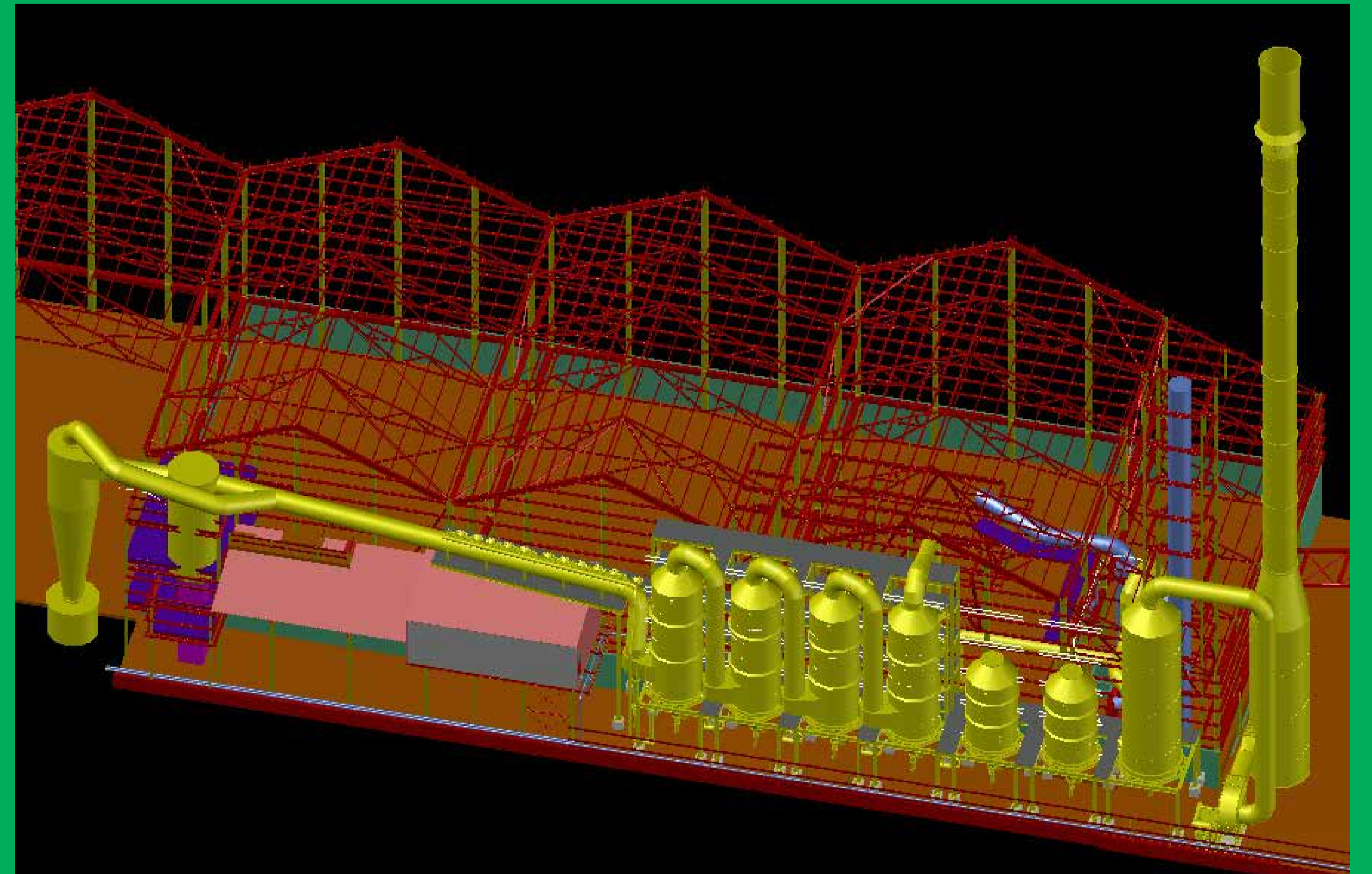

# Water Improvement Projects



# Listening to the local community

- Early stakeholder engagement with Technical Focus Group (TFG)
- Explored alternative water treatment and discharge options
- Preference of TFG based on te ao Māori and overall community values for land-based water disposal



# Air: strong controls become even stronger

---

- Treatment plant upgrades will further reduce concentrations of contaminants in site's air discharges
- Predicted concentrations of contaminants are well within relevant assessment criteria
- Potential effects of air discharges are considered to be low



# Impact of discharge

- Modelled future air emissions have less than minor health effects
- Modelled future air emissions unlikely to cause economic damage to crops
- Current water discharges are not impacting mahinga kai



# Water: precision irrigation preferred option

- Treated site water will be irrigated to neighbouring farm under controlled conditions
- Soils can adsorb any potential contaminants for decades (while growing feed for livestock)
- No effects on the underlying groundwater or nearby water takes



# Water: back-up option to discharge to new wetland

---

ravensdown 

- When weather or soil conditions prevent irrigation to land, site water will discharge to new wetland
- Discharge water quality will improve due to new treatment devices and overall discharge management
- Along with \$630,000 restoration project, this improved water quality will improve current ecological values





# Recognising significance to mana whenua

---

ravensdown 

- Genuine willingness to address concerns
- Creation of Guidance Komiti will maintain relationships with mana whenua to achieve environmental and cultural aspirations



# Habitat Abundance Restoration Project (HARP)

ravensdown 

- A partnership with mana whenua and Hawke's Bay Regional Council
- A new permanent wetland adjacent to site will improve biodiversity and provide opportunities to gather mahinga kai
- Idea came from engagement with mana whenua

Before



After

